



MTG 98-12 SAE

12V-97Ah - GEL Battery

APPLICATIONS



Electric Vehicles (EV)
Home Mobility Equipment (HME)
Cleaning Equipment
Aerial Work Platforms (AWP)
All cyclic applications

SPECIFICATIONS



Nominal Voltage		12V
80% DoD Voltage Cutoff		11.4V (1,90 VPC)
Nominal capacity @20 hour rate	1.75VPC	97Ah
Capacity at 25°C	Capacity at 25°C 10 hour rate	91Ah
	5 hour rate	85Ah
Shelf time @20°C up to 70%	in months	12
Self discharge	per month	<3% (20°C)
Operating temperature for (dis)charge		-10°C to + 50°C

DIMENSIONS



Dimensions LxWxH (T) in mm	329 x 170 x 205 (225)
Weight	31kg (±2%)
Terminal	SAE
Terminal torque setting	6 Nm
BCI-Group	31

CHARGING PROFILE (25°C in cyclic application)



IU Charging	I =	Min 10Amp / max. 15Amp
	U =	2.43 per cell
IUI Charging	I ¹ =	Min. 10Amp / max. 15Amp
	U =	2.38V per cell
	I ² =	Max. 2Amp (for max. 4 hours to max. 2.65V per cell)
Float-Voltage	U-float =	2,30VPC
Temperature compensation is 3 Mv per degree°C up or down from 25°C		

CYCLE LIFE



To maximize the cycle life of the battery, we recommend to charge the battery fully after use. The total life of the battery, is very dependant on the correct charge and depth of discharge per cycle.

FEATURES



- Maintenance-free bloc batteries in Gel technology
- Stable high current performance for extreme conditions
- High-class patented safety valve
- Valve-regulated lead-acid battery filled with thixotropic gel
- Classified as a non-spillable battery
- 700 cycles according to IEC 254-1



Pictured: M8 terminal

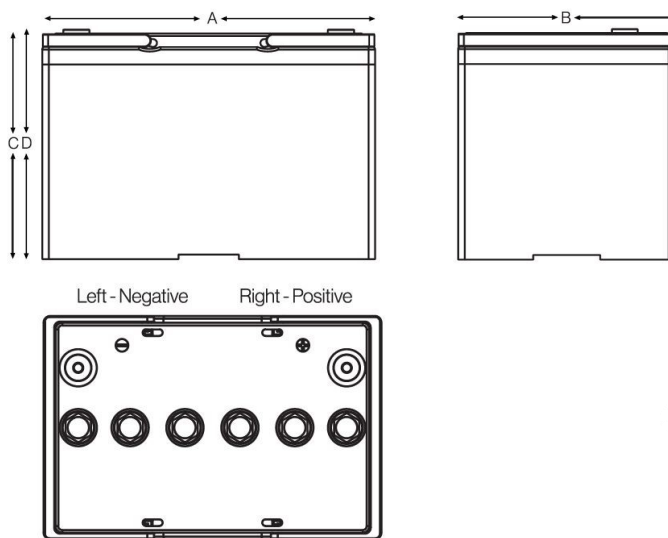

GEL Cycle Life vs Depth of Discharge at +25°C
Based on IEC 254-1

