

# MOVE

# MPA 200-6XL

6V-200Ah - Deep Cycle AGM Battery

## APPLICATIONS

Mobile Home Equipment  
Marine Applications  
Personal Carriers  
Cleaning Machines  
Utility Vehicles

## SPECIFICATIONS

Nominal Voltage	6V	
Nominal capacity @20 hour rate	200Ah	
Capacity at 25°C	10 hour rate	190Ah
	5 hour rate	175Ah
	1 hour rate	138Ah
Shelf time @20°C up to 70%	in months	9
Internal resistance (at 1 KHz)	approx. 1,65 mΩ	
Operating temperature for (dis)charge	-15°C to + 40°C	

## DIMENSIONS

Dimensions LxWxH (T) in mm	244x188x275 (275)
Weight	30kg (±2%)
Separator	AGM, Glass Matt
Case and cover	ABS
Terminal	M8 Insert
Torque setting (recommended)	M8: 10 Nm
Maximum allowable torque value	M8: 12 Nm

## CHARGING

Charging Voltage cycle use 7,2 to 7,45 Volt  
Float charge Voltage 6,8 to 6,9 Volt  
Charging current, minimum 25A - maximum 32A

## CYCLE LIFE

To maximize the cycle life of the battery, we recommend to charge the battery fully after use. The total life of the battery, is very dependant on the correct charge and depth of discharge per cycle.

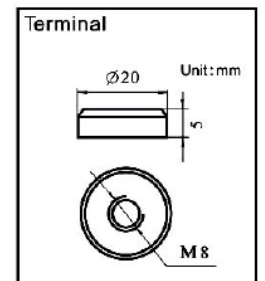
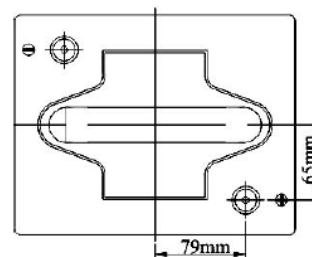
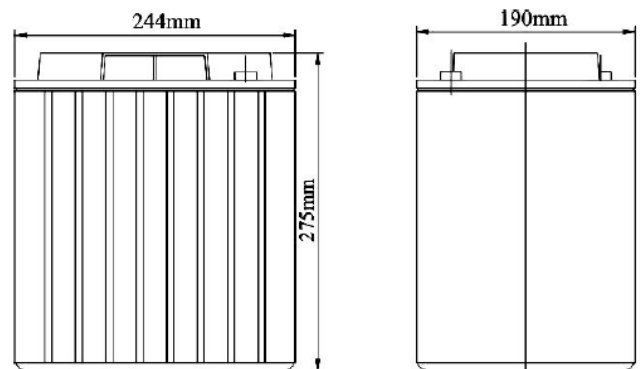

## BATTERY LIFE UNDER CYCLIC USE

Tested in conformance to the BCI testing method

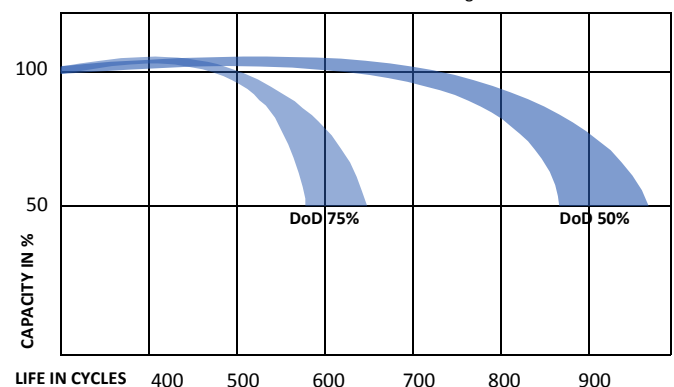

\* Cycle life is measured with a discharge current 0,2C, charged 16h and rest capacity of 2/3 Cn