



MDC 315-6 (305)

6V-315Ah - Flooded (WET) Battery

APPLICATIONS

- Suitable for all Motive, Leisure, Solar & Reserve Power applications
- AVP / Material Handling
- AWP
- Golf / Utility
- Industrial Applications

SPECIFICATIONS

Nominal Voltage	6V	
80% DoD Voltage Cutoff	5,6V	
Nominal capacity @20 hour rate	315Ah	
Capacity at 25°C	20 hour rate	315Ah
	5 hour rate	270Ah
Self discharge	< 3% per month (20°C)	
Storage temperature	-20°C to 60°C	
(Dis)charge temperature	-10°C to 50°C	

DIMENSIONS

Dimensions LxWxH (T) in mm	308x174x339 (365)
Weight	40,5kg
Terminal	DUAL
Terminal torque setting	Stud 11-12 Nm / AP 6-9 Nm

Note: there is a tolerance of ±2%

CHARGING PROFILE

IU Charging	I =	Min. 12% C5 / Max. 18% C5
	U =	2.45 per cell
IUI Charging	I ¹ =	Min. 12% C5 / Max. 18% C5
	U =	2.4V per cell
	I ² =	1,5% C5, for max. 4 hours

CYCLE LIFE

To maximize the cycle life of the battery, we recommend to charge the battery fully after use. The total life of the battery, is very dependant on the correct charge and depth of discharge per cycle.

FEATURES

- Compatible for deep cycle applications
- Good high current performance
- Ultra energy efficient due to low resistance
- Recyclable
- Long cycle life
- Low self-discharge rate
- Compliant with IEC 60254

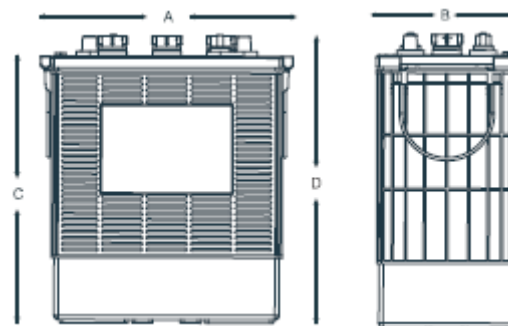

Left - positive

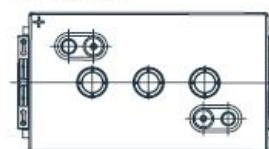

Right - negative

Dual

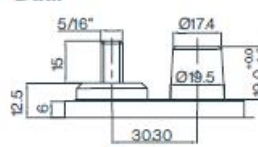

Positive

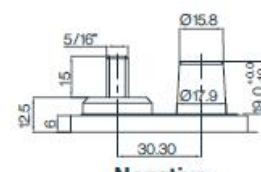

Negative

